



WWW.ICEUSA.COM
888-ICE-USA1

ICE® MODEL 8E EXCAVATOR - MOUNTED HYDRAULIC VIBRATORY DRIVER/EXTRACTOR

Excavator bucket circuit provides all hydraulic requirements.

Gear case design provides maximum vibrator speed and light weight.

Clamps available for single & double sheet piling, H-Beams, caissons to 4' (1220 mm), timber, concrete and pipe piles.

Optional gooseneck available for longer piles and greater reach.

Drives and extracts H-Beams, sheet piles, trench plates, pipe piles, guardrail posts and more.

360o swivel allows approach to task from any direction.

Adaptable for underwater operation.



MODEL 8E EXCAVATOR-MOUNTED VIBRATOR

Eccentric moment	785 in-lbs	90.4 kg-m
Maximum frequency	2500 vpm	
Maximum centrifugal force	69 tons	618 kN
Amplitude (free w/o clamp)	0.59 in	15 mm
Line pull for extracting	26 tons	235 kN
Crowd capability	26 tons	235 kN
Weight with standard clamp	5455 lbs	2475 kN
Non-vibrating Weight	1755 lbs	795 kN
Height overall (HH)	61 in	1542 mm
Height to pin without clamp (H)	36 in	912 mm
Length (L)	43 in	1103 mm
Width (W)	33 in	850 mm
Throat width (TW)	14.2 in	360 mm
Maximum pressure	4640 psi	320 bar
Maximum flow	73 gpm	275 lpm
Maximum power	197 HP	147 kw

* Does not include excavator stick yoke that adds 16"-20" (400-510 mm)

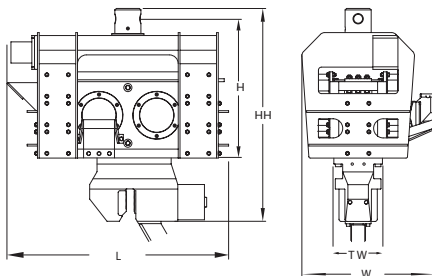

PERFORMANCE WITH CAT 330C EXCAVATOR

Frequency at low pressure	2030 vpm	34 Hz
Frequency at high pressure	1225 vpm	20 Hz

PERFORMANCE WITH CAT 245C EXCAVATOR

Frequency at low pressure	2500 vpm	42 Hz
Frequency at high pressure	2030 vpm	34 Hz



Designed and manufactured in USA by ICE®
World leader in cost-effective foundation equipment since 1974.

Constant improvement and engineering progress make it necessary that ICE®, Inc reserve the right to make specification changes without notice.
Please consult ICE® for the latest available information. © International Construction Equipment, Inc. All rights reserved. Jan 2015